

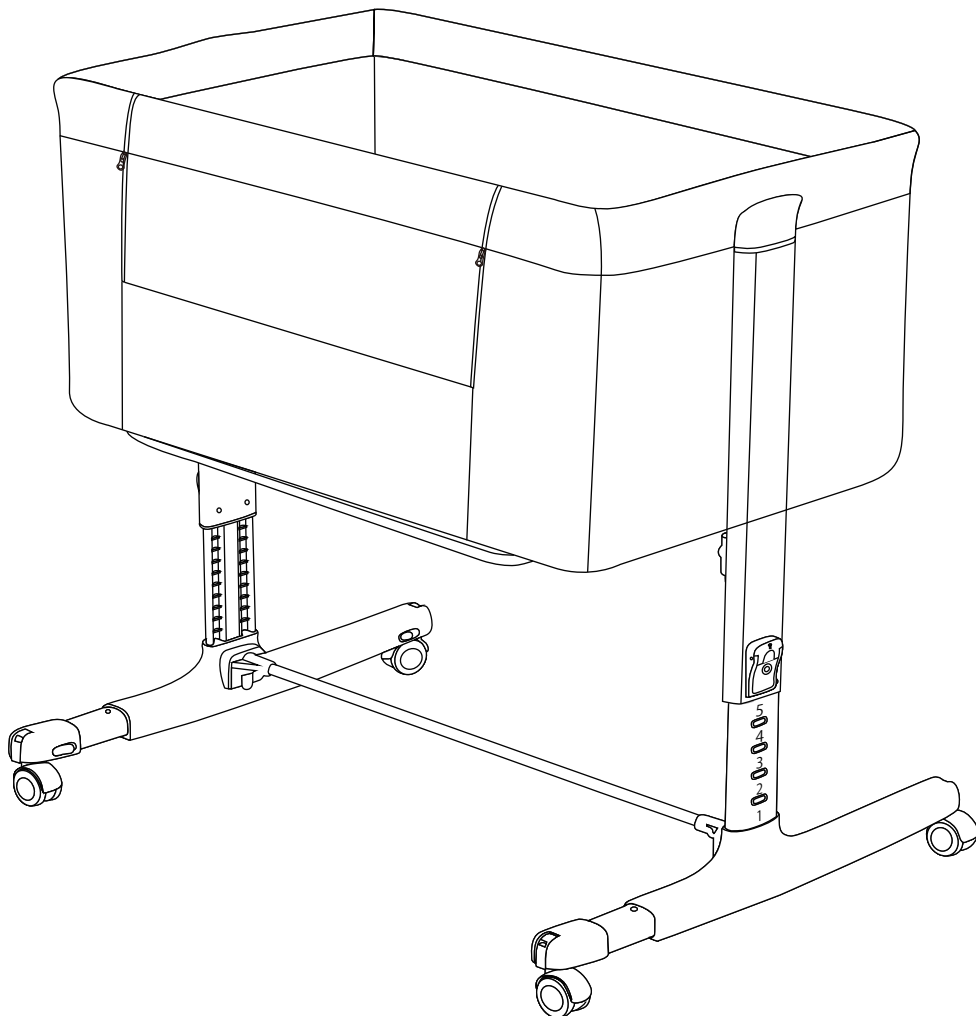

IMPORTANT! READ CAREFULLY AND KEEP FOR FUTURE REFERENCE.

Read the instructions carefully before use and keep them for future reference.
The child may be hurt if you do not follow the instructions. Adult assembly required.

Instruction leaflet Rockabye



Parts list

1. Main body
2. Mattress board
3. Mattress
4. Carry bag
5. Mattress support bar
6. Lower support bar
7. Base securing straps
8. Straps for fixing to parent bed
9. Left and right feet

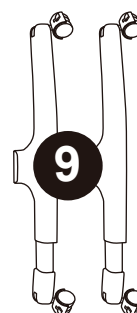
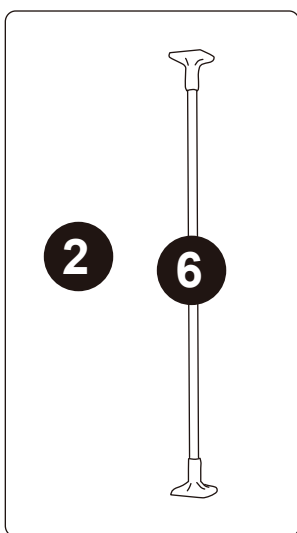
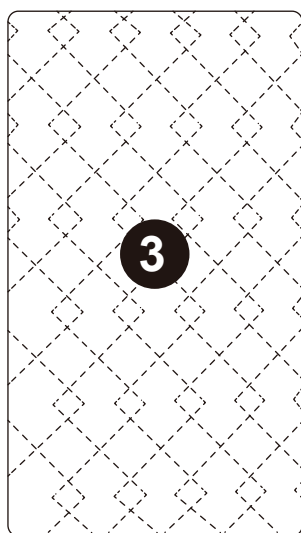
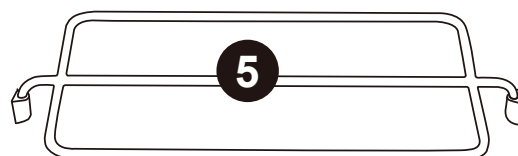
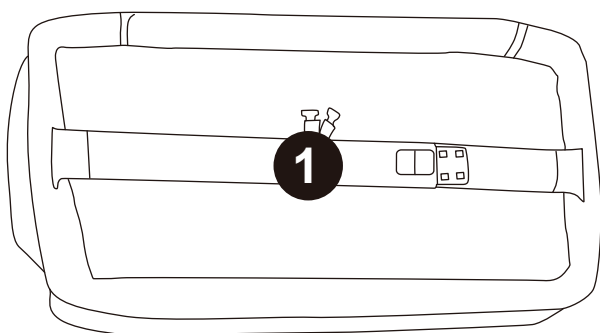

Assembly instructions

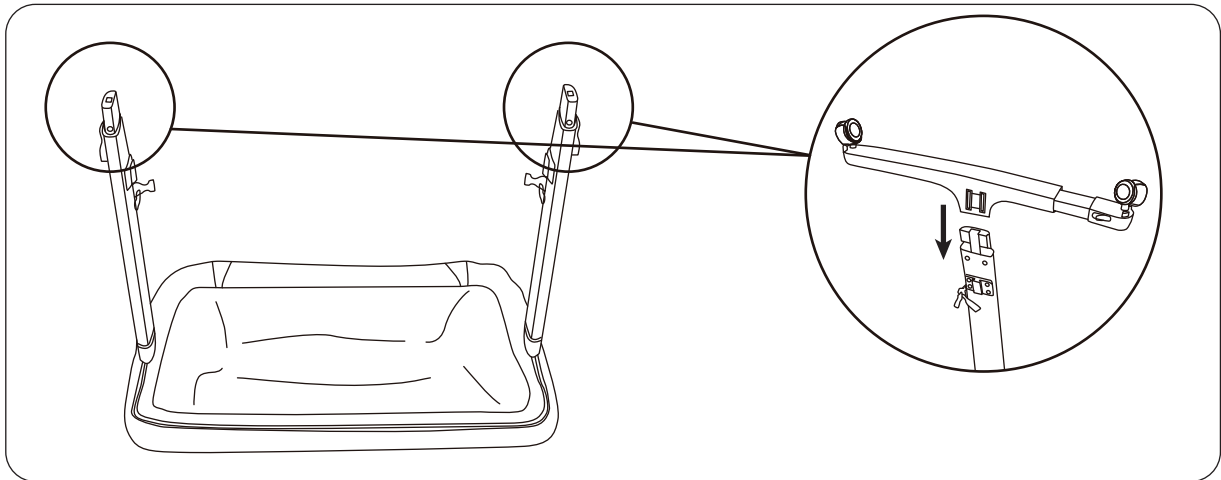

Attach the left and right feet onto the correct legs of the crib frame. [Each foot will only fit onto one leg].

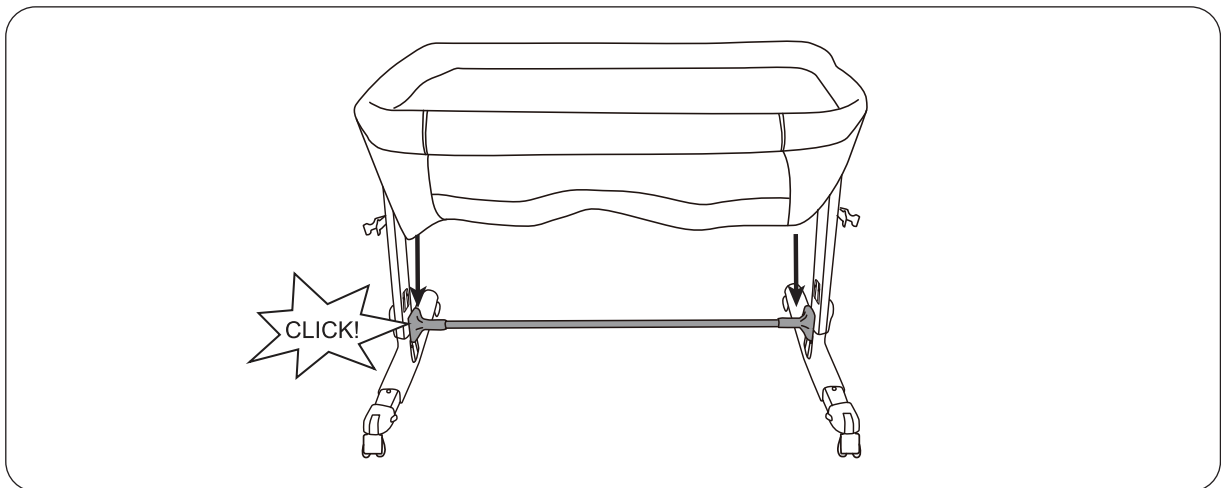

Insert the lower support bar into the slots on each foot and push down on both sides of the bar, ensuring that they click into place.

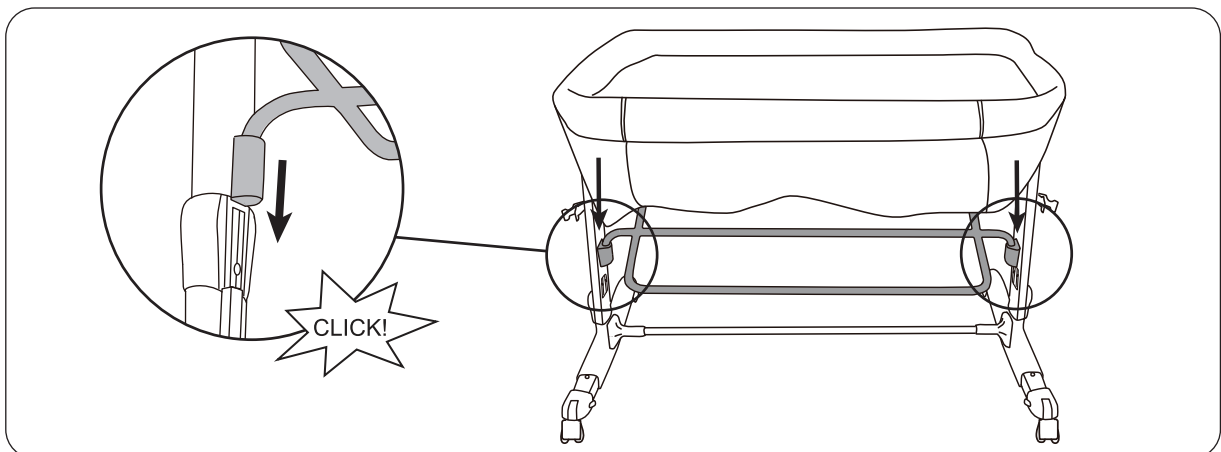

Insert the mattress support frame into the upper slots on the legs of the crib frame and push down until each side clicks into place.

Assembly instructions

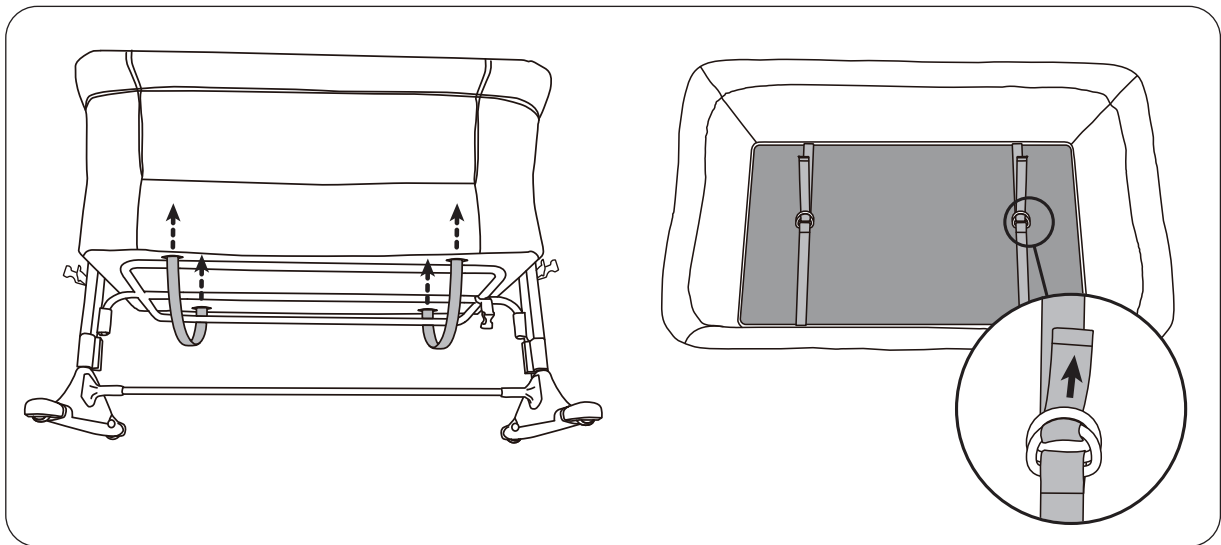

Place the mattress base board into the bottom of the crib. Then thread the base securing straps through the provided slots, around the frame and board then secure with the double rings, as seen above. Tighten securely.

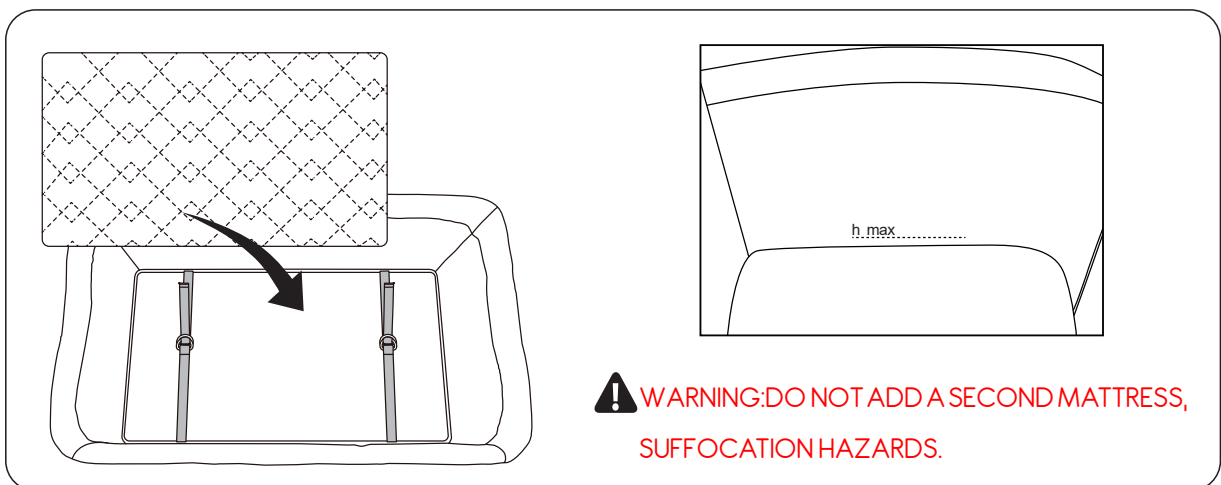

Place the mattress into the base of the crib.

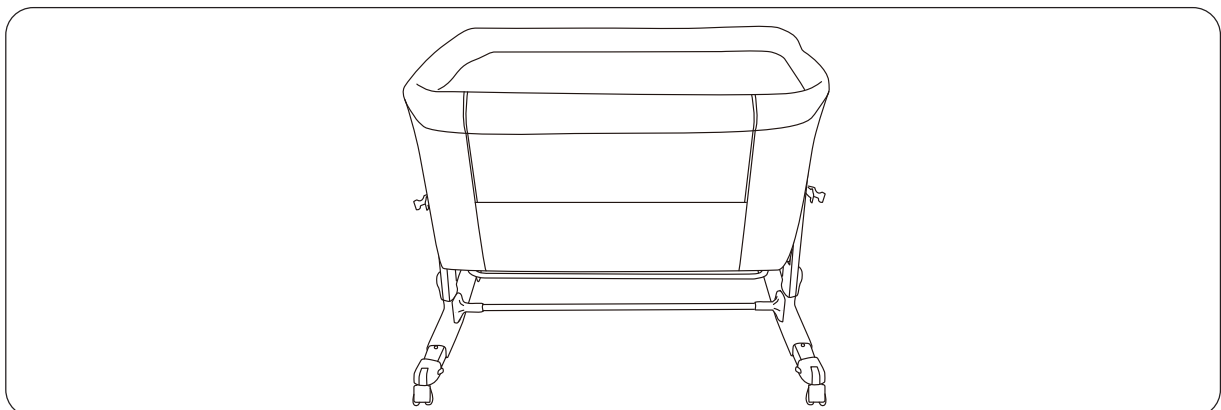

The assembly is now complete.

Height adjustment function

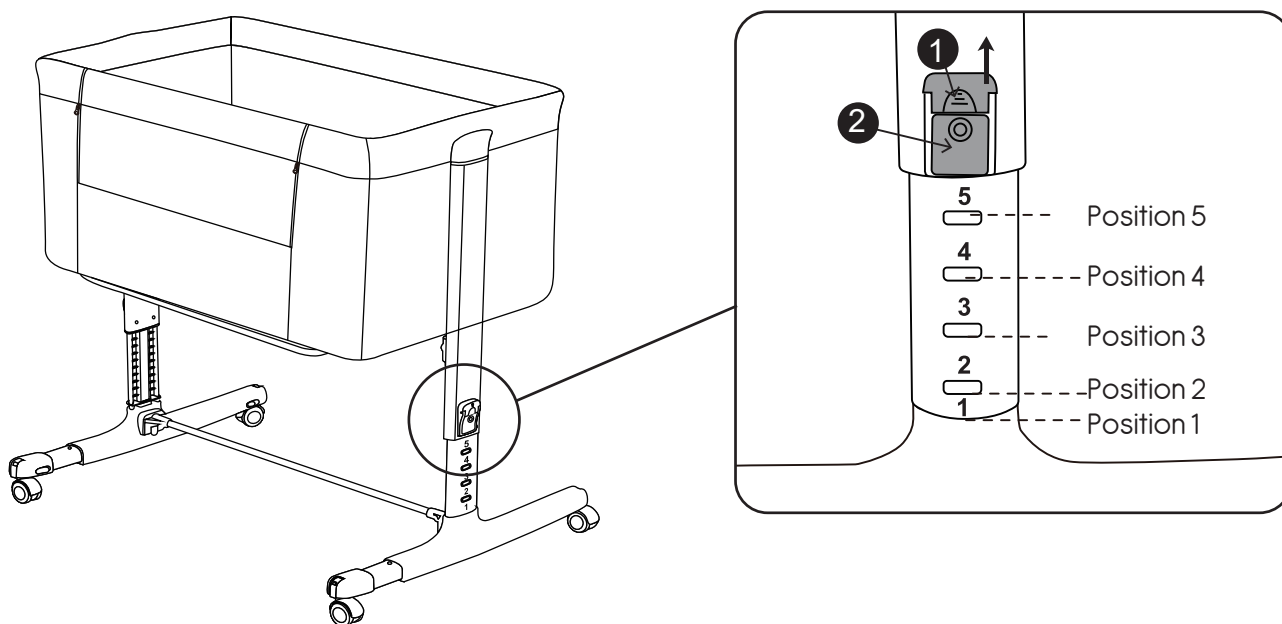

To lower height of the crib, slide up the catch (part 1) and then press in on the lower button (part 2). Adjust height as required and then release the catch button. Repeat for the other side.

To raise the height of the crib gently place one foot on the rocker by the main leg and with both hands, pull up on the top rail until you reach the desired height.

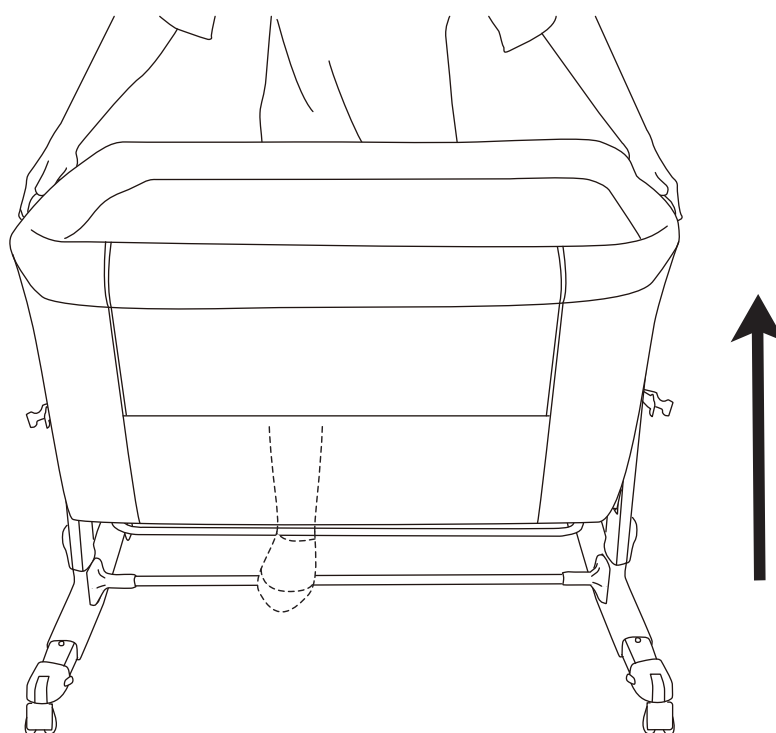

Rocking [crib] mode

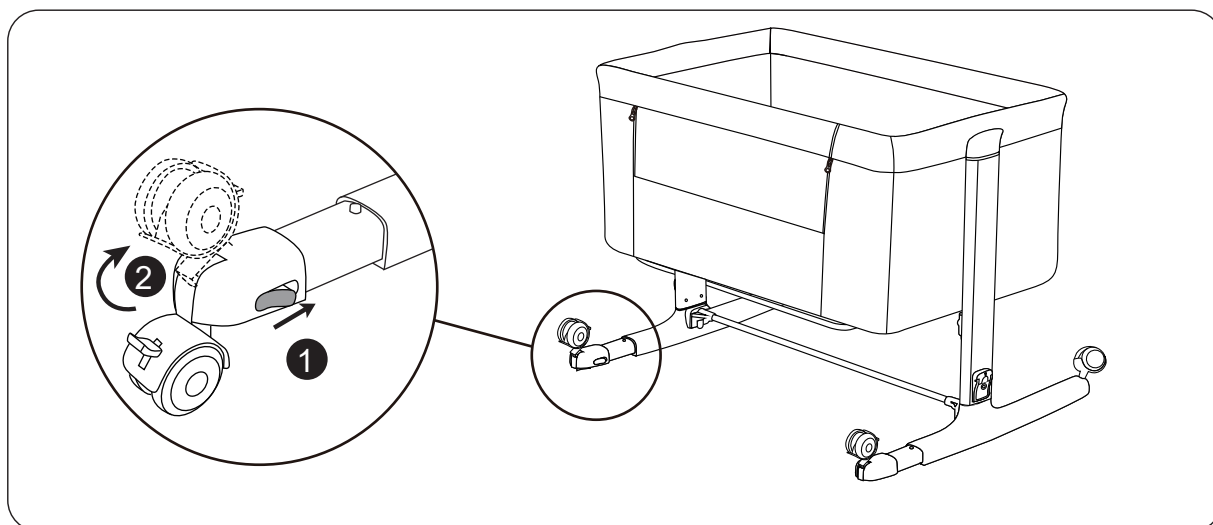

To put the crib into rocker mode simply push in the button located at the end of each rocker by the wheel and swing the wheel up or down as required.

Bedside [co] sleeper mode

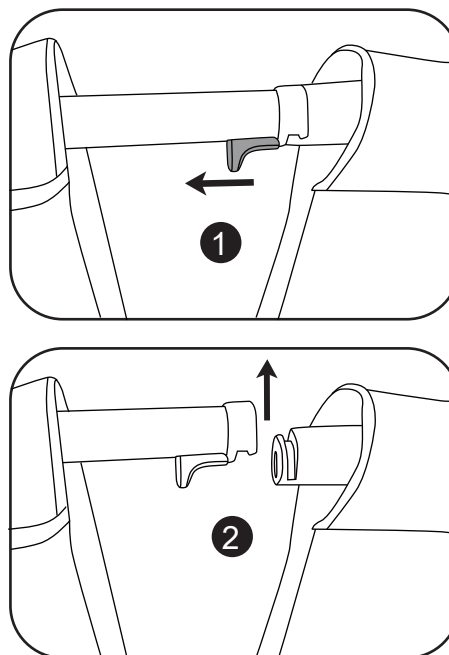
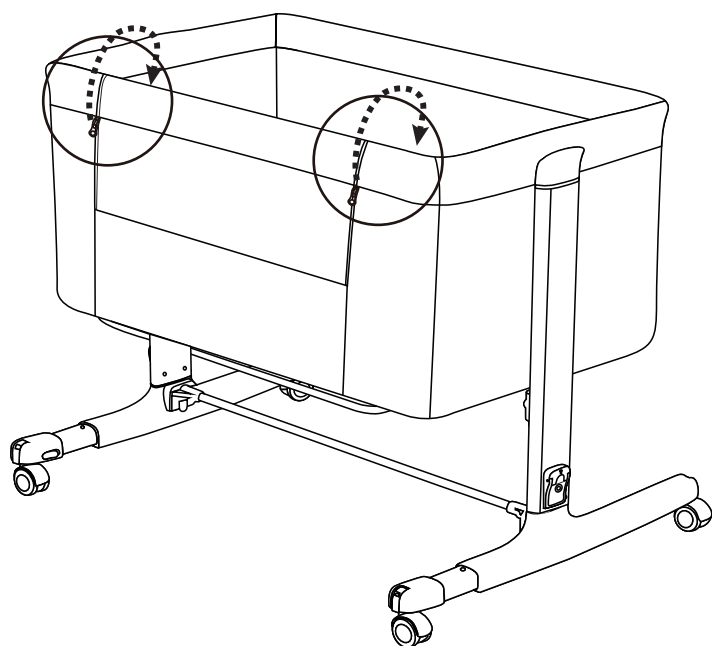

Unzip the two sides of the front panel then, use the slide release buttons on the detachable front rail and secure the bar with the two elastic loops at the base of the fabric crib.

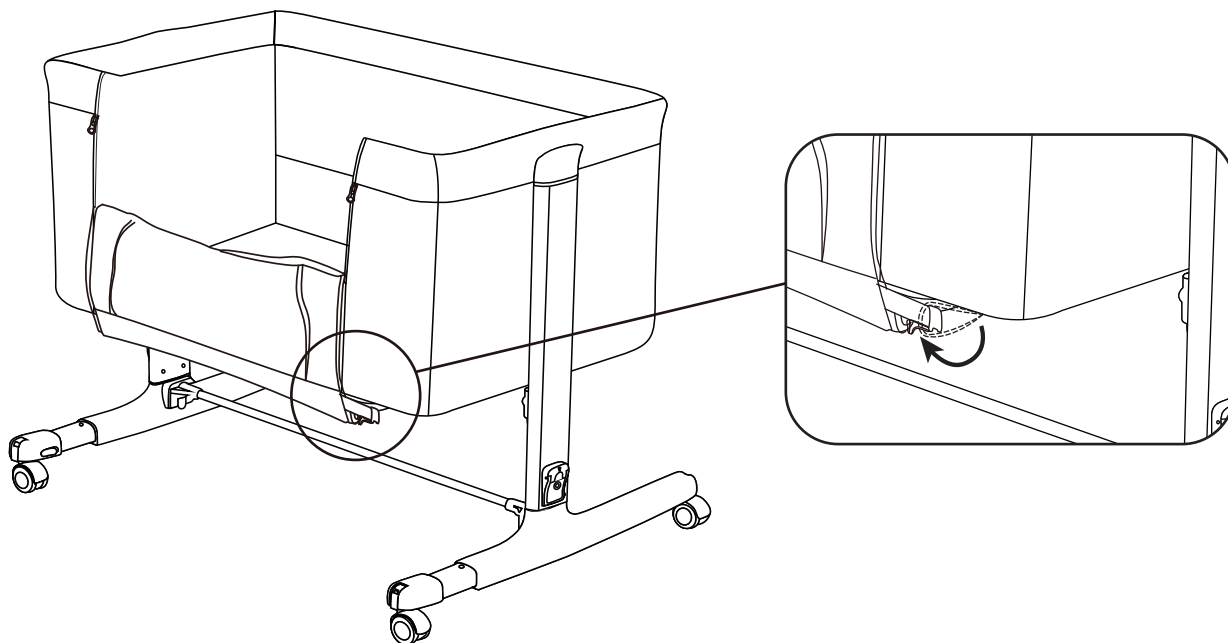

IMPORTANT Ensure that all of the wheels are down with the brakes applied when securing to an adult bed.

See the image below for the maximum height of the top of the adult's mattress.

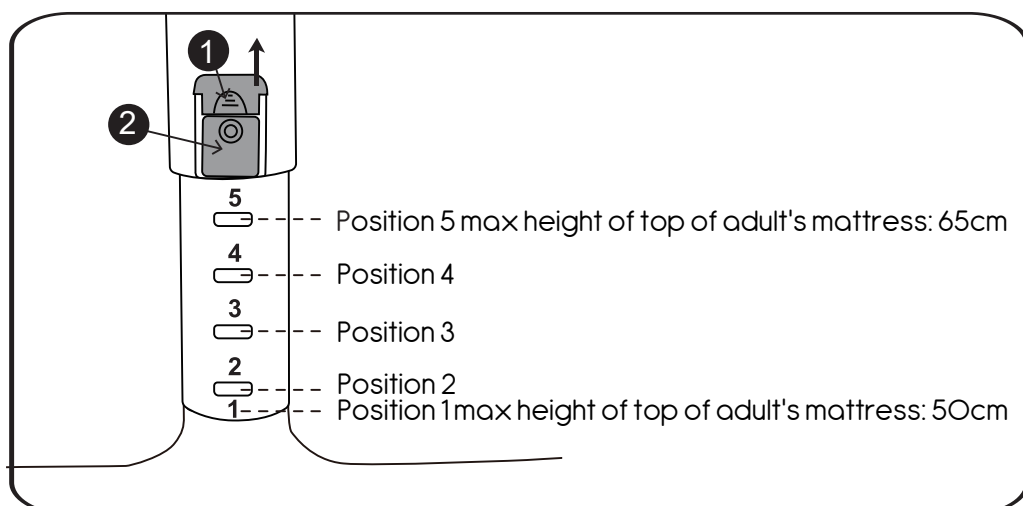

HOW TO USE THE BED ATTACHMENT STRAPS:

Connect one end of the bedside straps into the buckle on the side of the frame of the crib. Feed the strap under the mattress and either around the top of the mattress or around the bedframe.

Connect the other end of the strap buckle. Repeat for the other side.

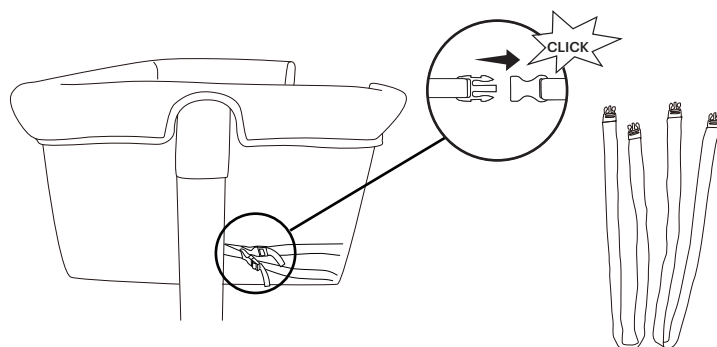

Pull on the loose ends of the belt to tighten it ensuring there is no gap between the adult bed and the crib.

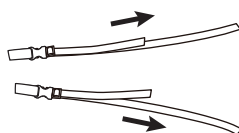

Align the crib beside the adult bed. Feed the "co-sleeper belt" underneath the adult mattress.

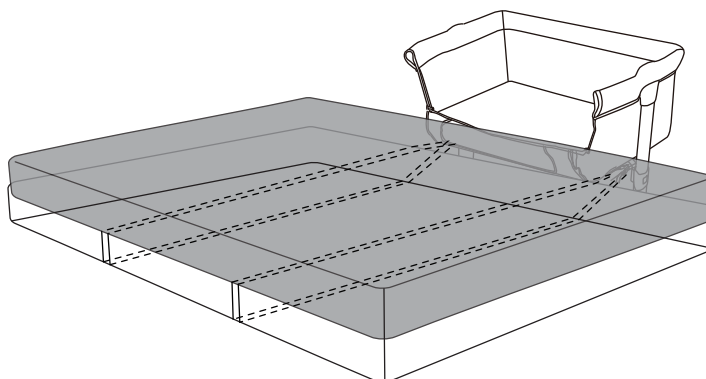

IMPORTANT

Press in the silver button on the retractable legs and push the crib next to the bed.

Clip both bed straps into the receptors on the crib and pull both loose strap ends

to ensure that the crib is securely attached to your bed. If there is any gap

between the bedside sleeper and the adult bed DO NOT use the product. Check

the tightness of the attachment system before each use by pulling the bedside

sleeper in a direction away from adult bed.

WARNING!

WARNING – To avoid hazards from the child's neck being caught on the top rail on the side that is next to the adult bed, the top rail must not be higher than the adult bed mattress.

Before every use always check to make sure there is no space between the parents mattress and the side of the Co sleeper.

If any space is found, pull the belts firmly to tighten until there is no space left and the correct position has been restored.

Only suitable for beds with straight sides.

Not suitable for beds with round mattresses or water beds.

When the product is used in the bedside sleeping mode, it should always be fitted to the long side of the bed.

Do not fix the co sleeper to the head or bottom of the bed.

Mattress and frame aligned

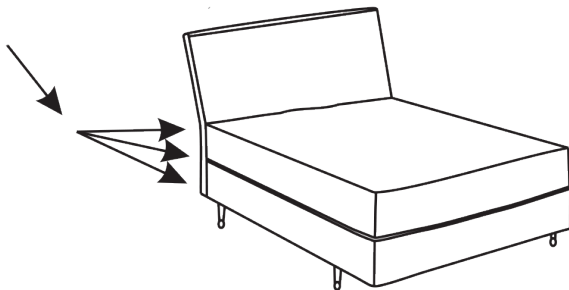

CORRECT
Bed frame and mattress in
line

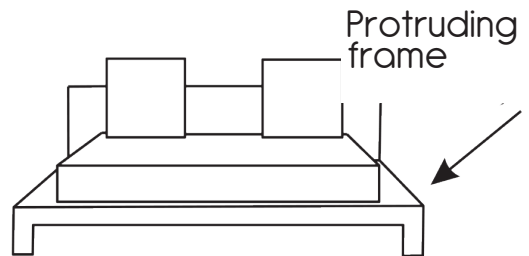

INCORRECT
Bed frame and mattress not in
line

Never use the Crib in Co sleeping mode without the anchor straps. Ensure the straps are securely attached to the adult bed.

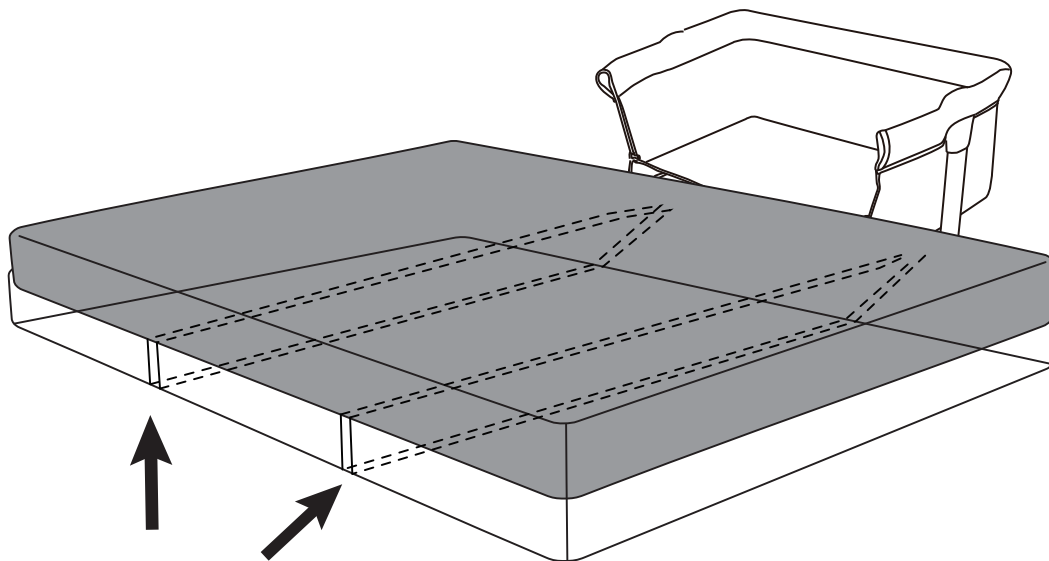

Anchor straps

To fold for storage / transportation

First, remove both of the base board securing straps (part 7).

Next, remove the lower fixing bar (part 6) and support tube (part 5) from the main vertical legs. Then fold one of the vertical legs over the top of the crib and one underneath. Stack all of the parts neatly and then place into the handy carry bag.

- WARNING: Do not use this product without reading the instructions first
- WARNING: Stop using the crib as soon as the child is able to sit unaided, pull itself up or push up on its hands and knees
- WARNING: The product is intended for use by babies aged 0 to 5 or 6 months, weighing a maximum of 9 kg.
- WARNING: Placing additional items in the product may cause suffocation.
- WARNING: Do not place the product close to another product, which could present a danger of suffocation or strangulation, e.g. strings, blind/curtain cords, etc.
- To avoid the risk of strangulation, do not place objects that have strings inside the crib.
- WARNING: Do not use more than one mattress in the product.
- Only use the mattress provided with the product or a replacement mattress approved by Red Kite.
- WARNING: Only use the mattress sold with this crib, do not add a second mattress on this one, suffocation hazards.
- The product must always be placed on a horizontal surface. Never leave the product on a sloping surface with your baby inside.
- Do not allow other children to play near the product without adult supervision.
- WARNING: When your child is unattended with the product in "Crib Mode", always make sure that the side is raised and locked in alignment with the upper perimeter of the crib.
- All components must be fastened well and screws must be tightened properly as they may pose an entanglement and/or strangulation hazard (e.g. strings on soothers etc.) for the baby.
- WARNING: Be aware of the risk of open fire and other sources of strong heat, such as electric bar fires, gas fires, etc. in the near vicinity of the crib.
- WARNING: When not attached to the bed, the crib can be inclined by a maximum of 2 positions between one leg support and the other.
- WARNING: DO NOT USE the product in "Crib Mode" and/ or "Co Sleeping Mode" if any part is missing, damaged or broken. Contact Red Kite for spare parts and user instructions if needed.
- DO NOT REPLACE missing, damaged or broken parts with components not approved by Red Kite.
- WARNING: The fixing straps are included in the packaging. Other fastening systems must NOT be used.
- When used in the "Co Sleeping Mode" (fastened to the bed), the crib must never be inclined.
- To prevent danger of choking due to the child's head being trapped, when the crib is in the "Co Sleeping Mode" (fastened to the bed) it must be properly fastened to the parents' bed using the fixing straps.
- WARNING: When the product is used in "Co Sleeping Mode" (fastened to the bed), before placing the baby inside be sure that the fixing straps have been properly fastened to the parents' bed and tightened.
- The product must be adjacent to the parents' mattress and there must be no gaps between the lowest part on the Co Sleeping side and the mattress for adults.

- WARNING: To avoid the risk of your child being strangled the attachment system to the adult's bed shall always be kept away from and out of the crib.
- Before assembling, ensure that the product and its components have not been damaged during transportation. If they have been damaged, do not use and keep out of reach of children.
- WARNING: Consult the user manual for the list of components. Examine the product regularly to make sure that there are no loose, damaged or missing parts.
- WARNING: Always use all parts needed for each configuration of use.
- Make sure that the adult using the product knows how it works, in accordance with instructions.
- WARNING: The product is ready for use only when all locking mechanisms are engaged. Make sure they are securely engaged before use.
- WARNING: When the product is being used, the wheels must always be locked.
- All operations for opening, adjusting, fastening and positioning the product must be carried out by an adult.
- Infants can suffocate on soft bedding. Avoid placing pillows or similar items under newborn babies for additional comfort during sleep.
- Do not leave anything inside the product that might reduce its depth.
- To prevent the child from being trapped, do not place the crib close to walls or obstacles.
- Do not leave any objects that might be swallowed inside the product.
- Do not make adjustments to the product when the child is in it.
- Do not move the product when the child is inside.
- Do not use the product with more than one child at a time.
- Prolonged exposure to sunlight may cause the colour of the product to vary in tone. After prolonged exposure of the product to high temperatures, wait a few minutes prior to putting your child in it.
- WARNING: During use, make sure that the parent's bedsheets, blankets, etc. do not invade the crib space.
- Keep the product out of reach of children when it is not in use.

Warnings:

WARNING! Do not use this product without reading the instructions first.

WARNING! – Stop using the product as soon as the child can sit or kneel or pull itself up.

WARNING! – Do not place additional items (e.g. toys, pillows...) in the product.

WARNING! – Do not place the product close to another product, which could present a danger of suffocation or strangulation, e.g. strings, blind/curtain cords, etc.

WARNING! – Do not use more than one mattress in the product.

Cleaning:

• Fabric may be spot cleaned by using a sponge with a mild soap and warm water solution. Leave to dry in a ventilated area away from direct sunlight. Do not dry clean, machine wash, bleach or tumble dry.

• Metal parts may be cleaned with a damp cloth. Always wipe dry.

• Clean plastic parts with a mild soap and warm water solution.

• Avoid leaving the product in direct sunlight for prolonged periods of time as this may cause fabrics to fade.

Mattress Information:

• The mattress may be spot cleaned by using a sponge with a mild soap and warm water solution.

Leave to dry in a ventilated area away from direct sunlight. Do not dry clean, machine wash, bleach or tumble dry.

• The maximum internal size of the product the mattress is designed for is 78 cm x 43 cm x 3cm. There shall be no gap larger than 30mm between the mattress and the sides and the ends.

• Mattress size: 78 cm x 43 cm x 3cm

• BSEN 16890: 2017 + A1: 2021

Manufactured by
The Red Kite Baby Co Ltd
35 Lavenham Road
Beeches Industrial Estate
Yate
Bristol
BS37 5QX
UK