

# red kite

## IMPORTANT READ CAREFULLY AND KEEP FOR FUTURE REFERENCE

### Instruction Leaflet

### Push Me Urbana

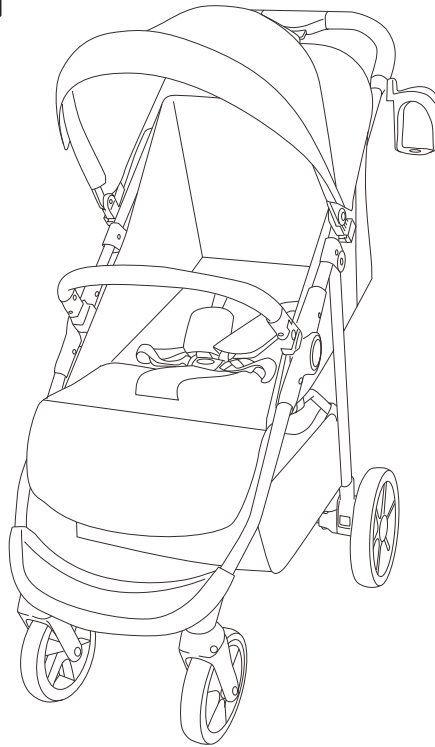

This vehicle is intended for children from birth up to a maximum weight of 22 kgs  
or 4 years whichever comes first.

Tested to: BS EN 1888-2:2018+A1:2022

Customer Care Line: 01454 326 568

PARTS LIST

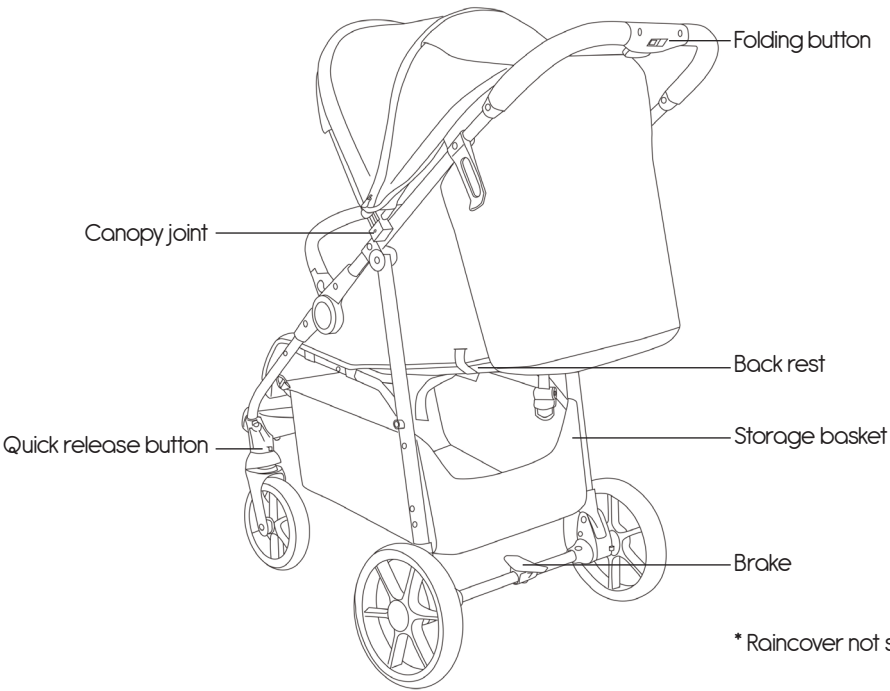
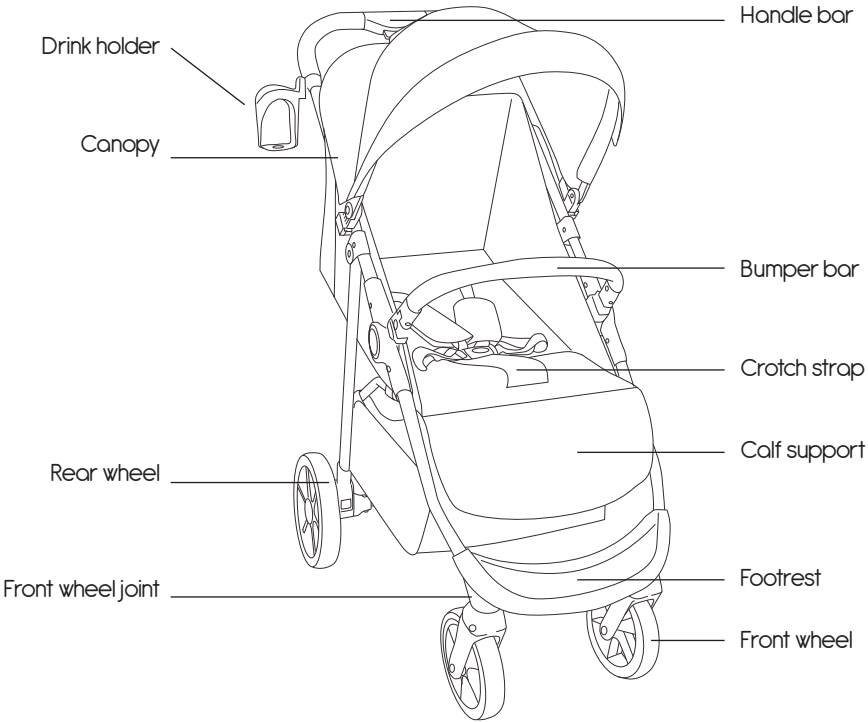

\* Raincover not shown

# ASSEMBLY INSTRUCTIONS

## TO OPEN THE STROLLER

Pull the retaining clip outwards and lift the handle upwards to lock the frame in place.

**WARNING** Ensure that all the locking devices are engaged before use.

Fig 1.

Fig 1

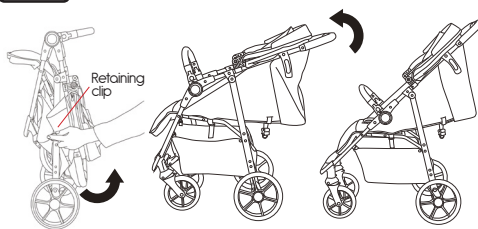

## TO INSTALL THE FRONT WHEELS

Push the stems of the each front wheel into the frame until they click in place. Pull down firmly to ensure they are attached correctly.

To remove the wheel, push in the clip on the back of the wheel.

Fig 2.

Fig 2

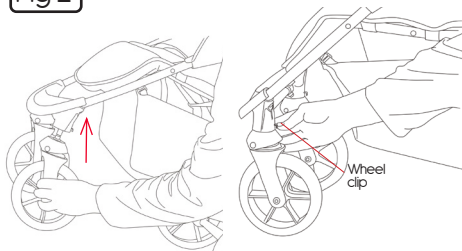

## TO ASSEMBLE THE REAR WHEELS AND BRAKE ASSEMBLY

Push the brake assembly on to the rear legs until it clicks into place. Pull the assembly downwards to ensure it is locked in place.

Push the stems of each rear wheel into the holes on the ends of the brakes until they click in place. Pull firmly to ensure they are attached correctly.

To remove the wheel, push the clip inwards and it pull the wheel out.

Fig 3.

Fig 3

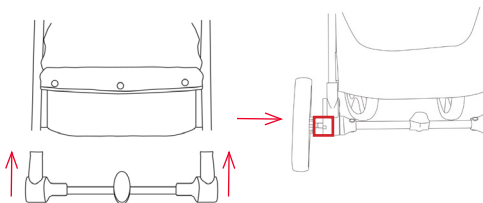

## TO ATTACH THE BUMPER BAR

Push the bumper bar in to the joints on each side of the frame.

To remove the bumper bar, press the buttons on each side and pull each side of the bumper bar out.

Fig 4.

Fig 4

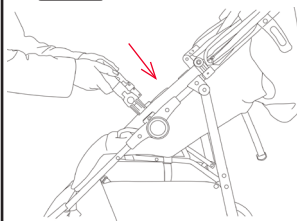

## TO ATTACH THE HOOD

Slide the brackets on the ends of the hood on to the blocks on each side of the frame. Pull backwards on the hood to ensure it is secure.

Push or pull the front of the hood to open or close the hood. You can extend the hood further by undoing the zip. Fig 5.

Fig 5

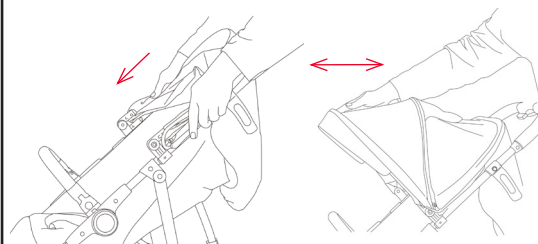

#### TO OPERATE THE BACKREST

To lower the back rest, squeeze the clasp on the back and pull downwards.

To raise the seat, hold the end of the strap, squeeze the clasp, slide it upwards and push the seat forward.

Fig 6.

Fig 6

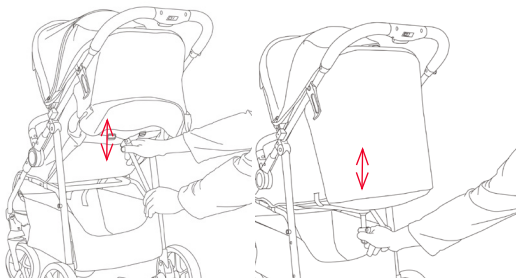

Fig 7

#### TO USE THE BRAKES

Press down on the back brake pedal to engage the brakes.

Lift upwards to release the brakes.

Fig 7.

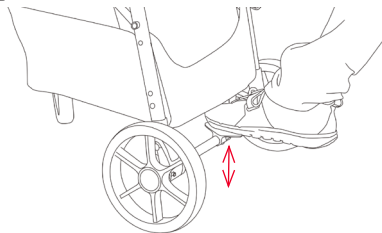

Fig 8

**WARNING** Apply all the brakes whenever you park the stroller.

#### TO ADJUST THE CALF SUPPORT

Squeeze the triggers on each side of the leg rest to and adjust it to the desired position.

Fig 8.

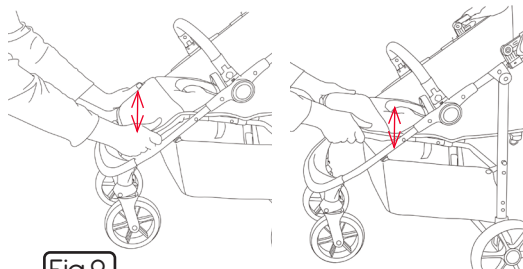
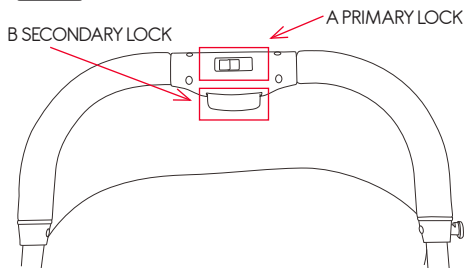

Fig 9



#### TO FOLD THE STROLLER

Fold the hood, slide button A to the side and then squeeze button B and lower the handle downwards.

The locking catch will automatically engage.

Fig 9.

TO SECURE AND ADJUST THE HARNESS.  
Slide the waist straps on to the shoulder straps and push into the crotch strap to attach the harness.

Press the button in the centre of the crotch strap to release the harness.

Adjust the waist and shoulder straps by means of the sliders to achieve a snug comfortable fit.  
Fig 10.

Fig 10

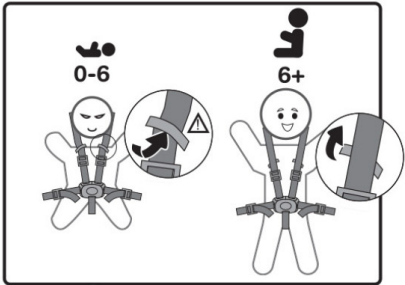
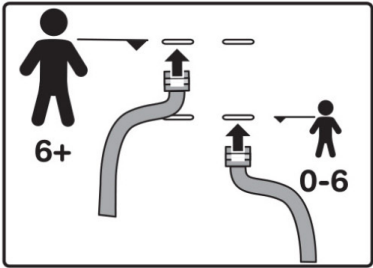

**WARNING!** For babies aged 0 – 6 months the harness must be fed through the retaining loops to prevent risk of strangulation.

**WARNING** Always use the crotch strap in combination with the waist belt.

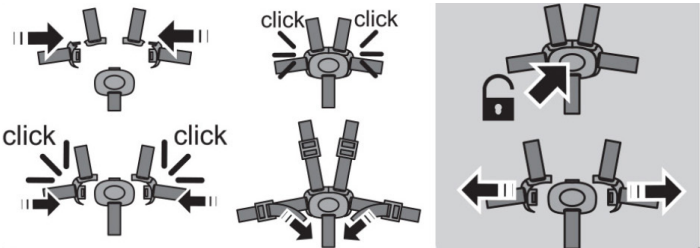
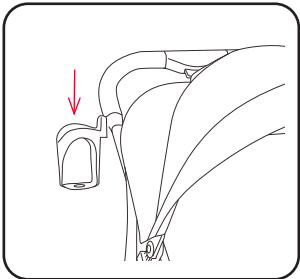

Fig 11

TO ATTACH THE DRINK HOLDER  
Push the drink holder down firmly onto the attachment points located on the right side of the frame.  
Fig 11.



## General care:

- The correct use and maintenance of this stroller is essential.
- Do not use excessive force when folding the stroller.
- If you are having problems, fully open the stroller and repeat the folding procedure.
- Always let wheels down as gently as possible when mounting and dismounting kerbs.
- Always fold the stroller when going up or down stairs.
- Never bump the stroller over these or similar obstacles.
- In some climates mould and mildew can affect the fabric and rain cover. To avoid this, do not fold the stroller when it is wet. Leave it open in a ventilated area until completely dry.
- Always store the stroller in a dry place.
- When storing the stroller in the car, never place other items on top of it.
- Do not exceed the maximum load of 2 kgs in the shopping basket. (Where provided).

## Cleaning:

- Fabric covers and trims may be spot washed using mild detergent and warm water. Leave to dry in a ventilated area away from direct sunlight.
- Avoid leaving your buggy in direct sunlight for prolonged periods of time as this may cause fabrics to fade.
- Do not dry clean, machine wash or tumble dry.
- Metal parts may be cleaned with a damp cloth.
- Always wipe dry. Clean plastic parts with a mild soap and water solution, wipe dry.

## Maintenance:

- Maintain your stroller by lubricating all metal moving parts with a silicone based lubricant. Do not use heavy machine oil or grease as this can attract dirt or grit.
- Check that nothing is loose or broken and that no sharp edges have been exposed. Inspect all joints and the harness, replace any damaged parts immediately.
- Inspect any nuts and bolts regularly to ensure none have worked loose. Tighten as necessary.
- Only use replacement parts and accessories that have been approved by the manufacturer. Failure to do this may invalidate your warranty.

## Safety warnings:

WARNING Never leave your child unattended.

WARNING To avoid injury ensure your child is kept away when unfolding and folding this product.

WARNING Do not let your child play with this product.

WARNING Always use the restraint system.

WARNING This product is not suitable for running or skating.

WARNING Your child's safety is your responsibility.

WARNING Any load attached to the handle affects the stability of the pram / pushchair.

WARNING Ensure that all the locking devices are engaged before use.

- Not intended for children weighing more than 22 kgs.

This stroller is designed for one child only.

- The brake must always be engaged when placing and removing children from the stroller.

- Any load attached to the handle and/or on the backrest and/or on the sides of the vehicle will affect the stability of the stroller.

- Do not attach a buggy board or similar product for a child to ride on.

- Lift a child in and out of the stroller. Do not allow a child to stand on the footrest or seat.

- Do not use accessories that have not been approved by the manufacturer.

- Never use the buggy to carry a child up and down stairs or escalators. Remove your child and fold the pushchair when going up or down stairs / escalators.

- For newborns, it is advisable to use the seat unit in the fully reclined position.

- Not suitable for use on the beach. Sand will damage the wheel bearings and make the product hard to use.

Tested to: BS EN 1888-2:2018+A1:2022

For all technical queries please call: 01454 326 568

Manufactured by:

The Red Kite Baby Co Ltd

35 Lavenham Road, Beeches Industrial Estate, Yate, Bristol, BS37 5QX. UK.